



BOATCONTROL

User manual

App v4.0.0 – August 2025

Table of contents

Technical specifications 2

Set up 2

1. **In the package:** 2

2. **Electrical set up of the box** 2

• **Making connections** 3

• **Power Supplies**..... 3

• **Important Specifications for Channels** 3

• **Final Steps** 4

3. **App Setup** 5

a. **Signup/Login** 5

b. **Connection - Bluetooth** 6

c. **Connection – Wi-Fi** 8

d. **Disconnection – Wi-Fi** 9

a. **App Setup - Continued**..... 10

Settings 13

Additional Connections 14

Warranty..... 15

Technical specifications

- **L x W x H:** 253 x 158 x 61 mm
- **Power supply:** 9 to 30 VDC
- **Normal power consumption:** 3 W, max 6,5 W
- **Peripherals:**
 - **Channels:** 14 contacts 10A, max load 100A
 - **Ports:** 5-pin to NMEA2000
- **Connectivity:** Bluetooth, Wi-Fi and Cloud
- **Status indicators:** Blue for power, yellow for NMEA2000
- **Orientations:** Vertical / Horizontal
- **Mounting:** 225 x 100mm with ø5mm mounting hole

Set up

1. **In the package:** You will have a BoatControl box and 2 options of glands that you can use.



2. Electrical set up of the box

- **Open the Box**
 - **Note:** Be careful while separating the lid and base as the 5 pin is having connection to the lid, so make sure you do not pull it apart with much force.

- **Making connections**

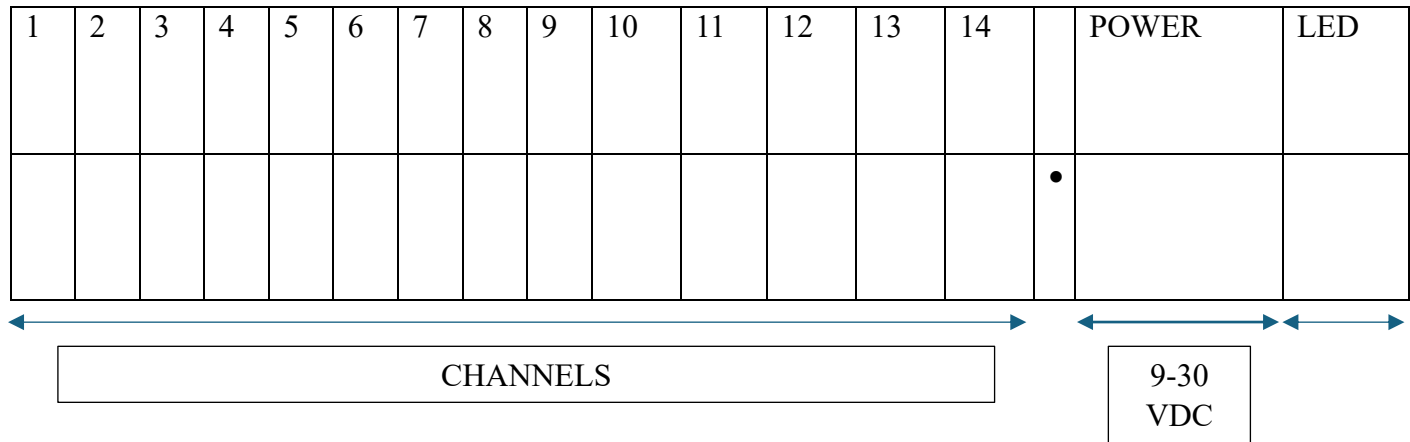

Connect each channel to your desired output device to control.

For example, to connect a Cabin light, take the positive from power supply and connect to left pin of relay/channel 1 and take the positive from cabin light and connect to right pin in relay 1; make sure to make it common ground for output devices and power supply.

- **Power Supplies**

Connect a supply voltage between **9-30 VDC**, preferably **12V** or **24VDC**.

When the power is turned on, the blue light on the lid will illuminate, indicating that the power supply is active.

- **Important Specifications for Channels**

Each channel/switch can control voltages between **12V** and **24V** with a maximum current of **10A**.

The total simultaneous load of all channels must **not exceed 100A**.

The channels are independent and isolated, preventing short circuits between them.

Each channel functions as a switch without a direct connection to the BoatControl power supply.

It does not matter which pin on a channel receives the positive connection.

It is possible to run 24V on one channel and 12V on another.

The channels can be connected both in parallel and in series.

- **Final Steps**

- ✓ Note the serial number written inside the box.
- ✓ Mount the box on the boat using the four mounting holes on the base plate.
- ✓ Once all connections and mounting are complete, close the lid.
- ✓ If necessary, connect the NMEA2000/EPT LV battery devices to the 5-pin socket.
- ✓ Use a T-connector if multiple devices are connected.

3. App Setup

a. Signup/Login

- After the electrical installation, download the app from the App Store or Play Store, or scan the QR code below.



Note: This version of user manual configures with the latest app update – version 4.0.0 as of 1st August 2025. Older app versions might not follow the same procedure.

- Sign up with your email address and password or log in if you are already a user.

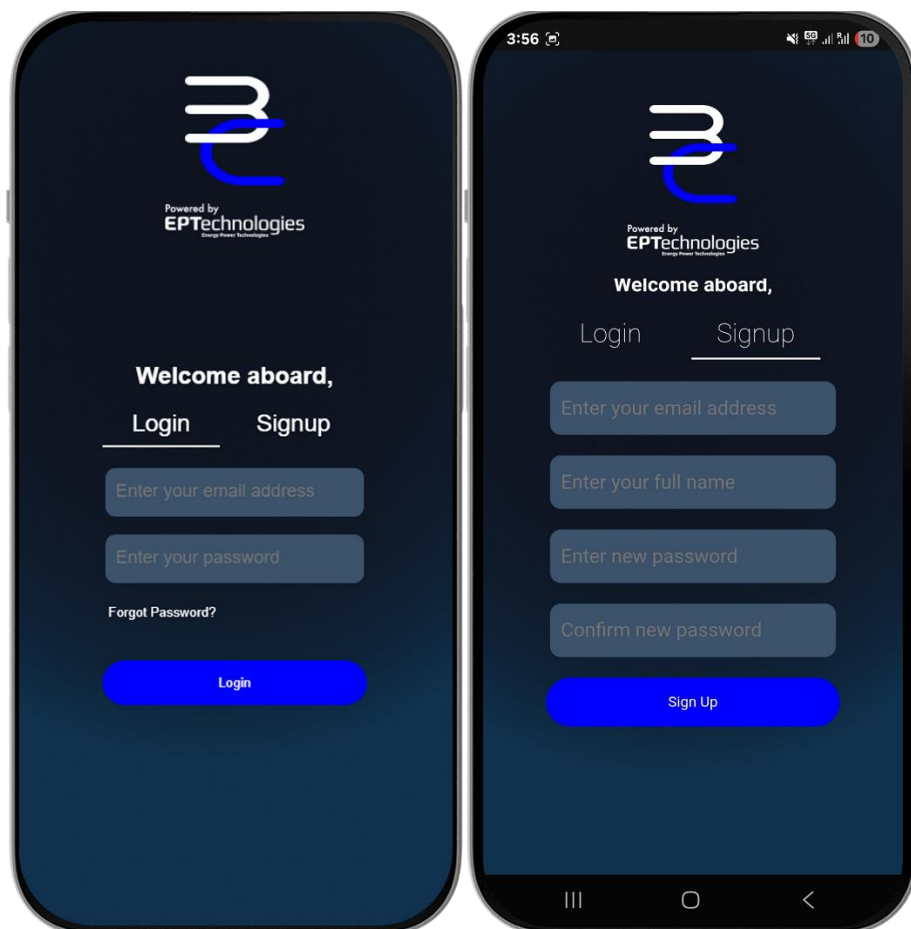

b. **Connection - Bluetooth**

- Make sure Bluetooth is turned on. When BoatControl is powered on and Bluetooth is on, a pop up comes up for pairing. It will show the device number when asking for pairing. If it does not show up, click on the + icon on the app page after login. Note: If you have already paired, the device will appear on this page. If it does not appear go to the + icon again and scan.

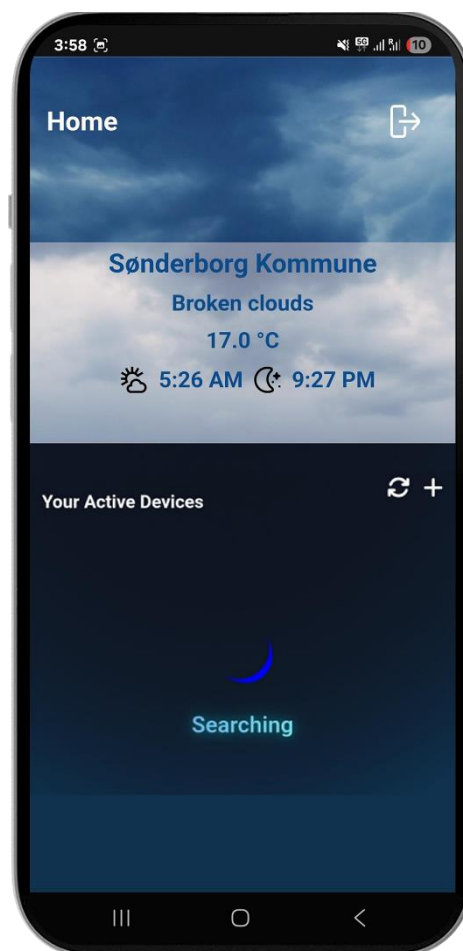

- Click Pair when it pops up with your device number.
- You will be redirected to the first page after pairing is complete. *Do not exit before this.*
- When it is successfully paired, you will see a new device on the page with a green icon for Bluetooth. Now Bluetooth connection is established. You can click on the device and connect to devices. Now BoatControl works in Bluetooth mode with relays and NMEA.

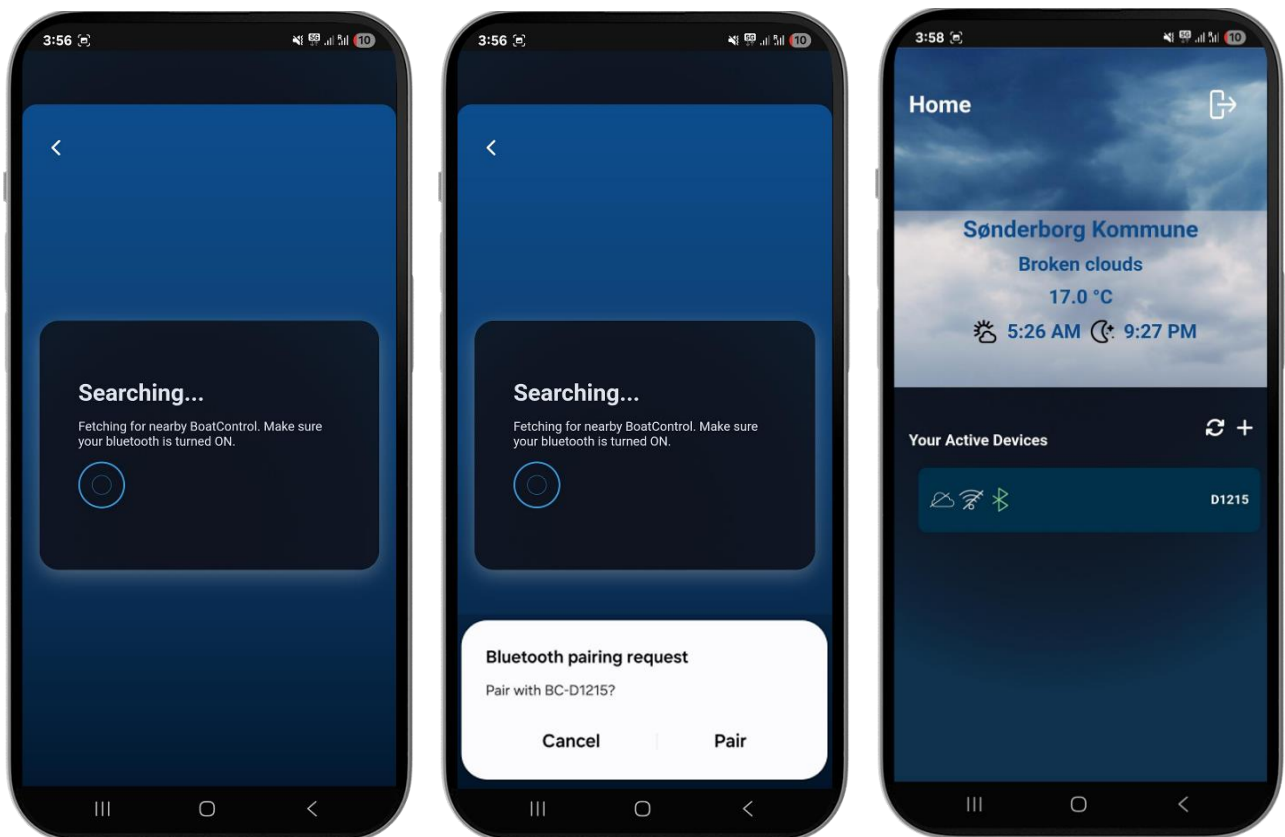

- You can automate your devices in Bluetooth mode by turning on and off the relay in the channels page. Also, the user can rename it for easiness.

c. **Connection – Wi-Fi**

- For connecting Wi-Fi click on your device, you will see a settings icon (gear button) on top right of the app then go to Wi-Fi setup and connect using the password. After Wi-Fi connect, close the app and open it again. You are now connected using Wi-Fi and cloud.
- You can now automate and view relays and NMEA using Wi-Fi connection.
- Wi-Fi is required to view the EPT system data – Battery, motor and other EPT specific information.

IMPORTANT: after connecting Wi-Fi, unplug the BoatControl power and wait for 5 seconds and power it on again and Wi-Fi will be successfully connected. Wait till Wi-Fi icon is green.

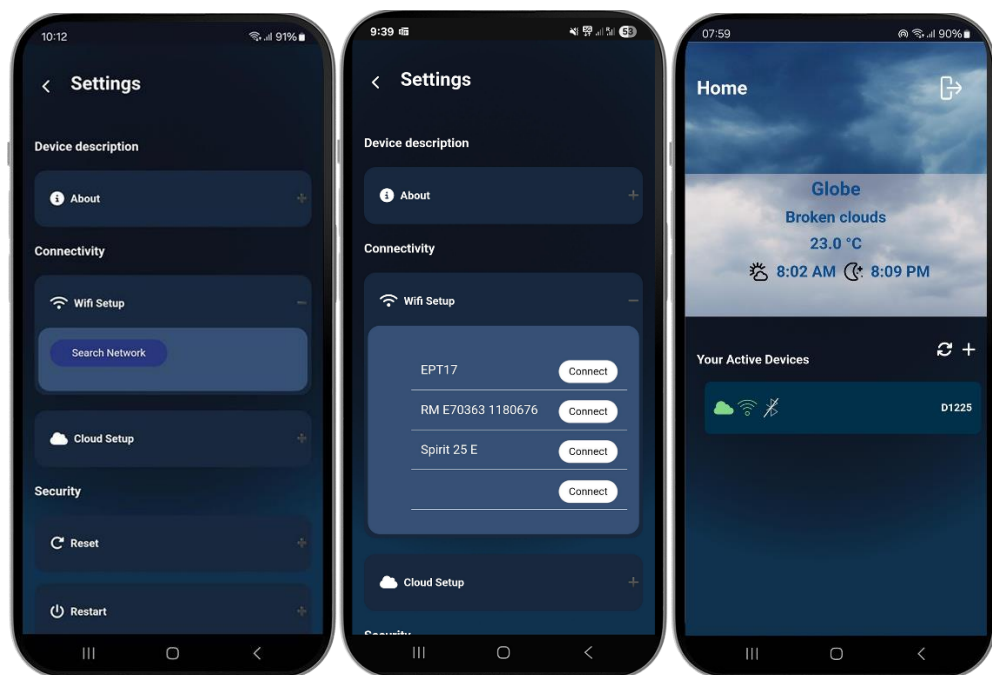

IMPORTANT: Complimentary cloud services are only available for an introductory period, after that a fee of 80 EUR/600DKK per year is required to avail this service. The user can renew cloud service by paying directly through the settings page > cloud setup.

d. **Disconnection – Wi-Fi**

- Do the similar way if you disconnect Wi-Fi. After clicking the disconnect button, cut the power supply to the BoatControl for about 5 seconds and re-power it again. After Wi-Fi disconnect, close the app and open it again. Wait till you see the Bluetooth icon to turn green.
- You are now connected via Bluetooth again
- Now, click on the device (e.g., D-1215), and you will see three pages: ***Channels, Insights, NMEA, and Battery.***

Note: It may take up to 30 seconds to switch to Bluetooth mode automatically.

IMPORTANT: To connect a new Wi-Fi, first the user needs to disconnect Wi-Fi from the existing station and wait until 30 seconds for the BoatControl to set back to bluetooth mode to search for new station. After the bluetooth mode is established , go to the settings page again and connect the new wifi

The user can view the current connection by the color on the cloud, Wi-Fi and Bluetooth icons in the home page

If the already connected Wi-Fi is not available and if app does not respond anything, reset the BoatControl using, Reset option in the settings page. Then the user will be able to start again.

a. **App Setup - Continued**

- You can control your devices through the *Channels* page. Simply tap the respective channels to turn them on and off. You can also customize channel names and icons using the Edit button at the top. It will take 2 seconds to refresh this page.

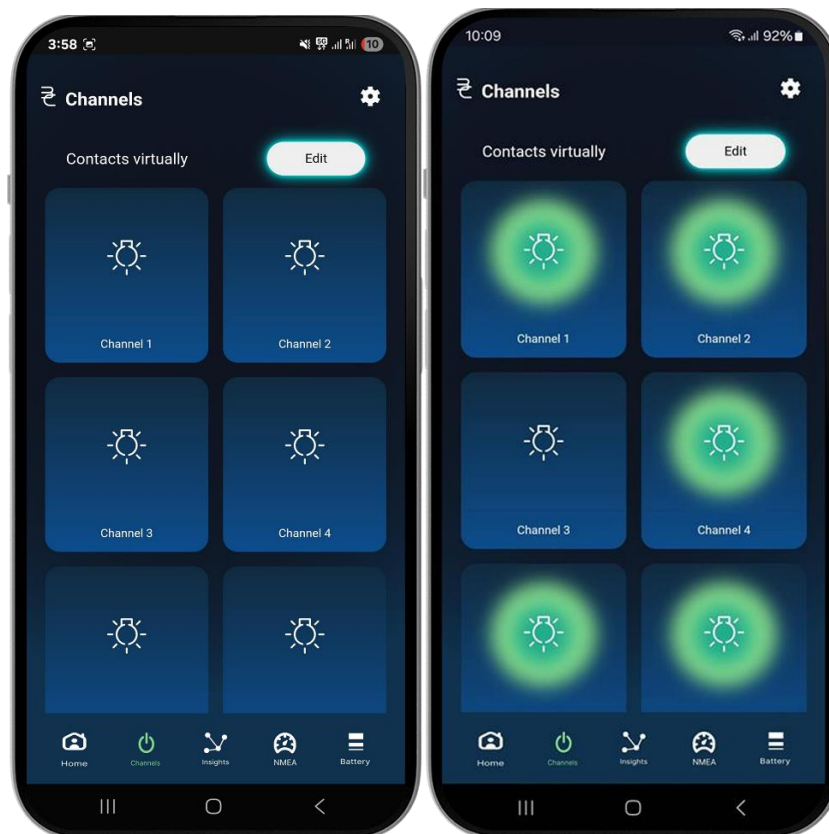

- If NMEA devices are connected to the 5-pin port, you can view them on the NMEA page by adding them, allowing you to see only what you wish to monitor.

- **Note:** We have increased the number of NMEA devices to 13, and these are the available connection options:

- Temperature Gauge
- Water Tank Gauge
- Atmospheric Pressure Gauge
- Septic Tank Gauge
- Fuel Level Gauge
- Course
- Grey Water Tank Gauge
- GPS
- Oil Level Gauge
- Rudder Indicator
- Wind Gauge
- Fish Tank Gauge
- Black Water Tank Gauge



- Connect to the EPT LV battery to monitor the real-time overall health status of the battery.
- **Note:** During the initial setup, ensure that no devices are connected to the 5-pin port. After connecting the battery, turn BoatControl off and on again. Once the battery is connected, you will see the readings in the app. After confirming the readings appear in the app, you can reconnect all previously connected NMEA devices (if any). Additionally, in the current version, if your battery is in deep sleep mode, you may not see any readings. Connect a load and then check if the values appear.

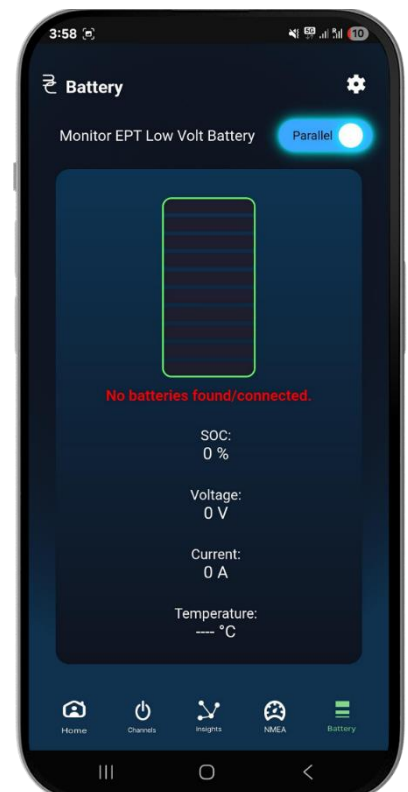

- If you have an EPT system, you can also connect it to view system data such as:
 - Motor speed
 - Temperature
 - High-voltage battery readings
 - Propeller data, etc.
- Connect the 5-pin cable to the 5-pin port in the box. You can also use a T-connector to connect multiple devices at once to the 5-pin port in the box.
- If you miss data at some point check network strength and connection, go to the main page and see if the cloud /Wi-Fi is green in color and still no data is received restart the BoatControl through restart option in the settings



Settings

- **Instructions**

Find detailed setup guides and startup instructions.

- **Software Update for BoatControl – Firmware**

If an update is available, an icon will appear at the top of the app. You can update by tapping the icon and then pressing the "Download & Install" button.

- **Wi-Fi Setup**

Connect or disconnect Wi-Fi using this option.

- **Cloud Setup**

Cloud services are available to all users until December 2025. If you wish to continue using cloud services afterward, you must purchase access through this option.

- **Restart BoatControl Box**

Press "Restart", and the box will reboot, becoming unavailable for the next 10-20 seconds. The contacts will remain unchanged.

- **Reset BoatControl Box**

You can reset your box here.

⚠ WARNING: Using this function will reset the box, delete all settings, and remove the pairing with your account.

- **Change Password**

You can change your current password to a new one.

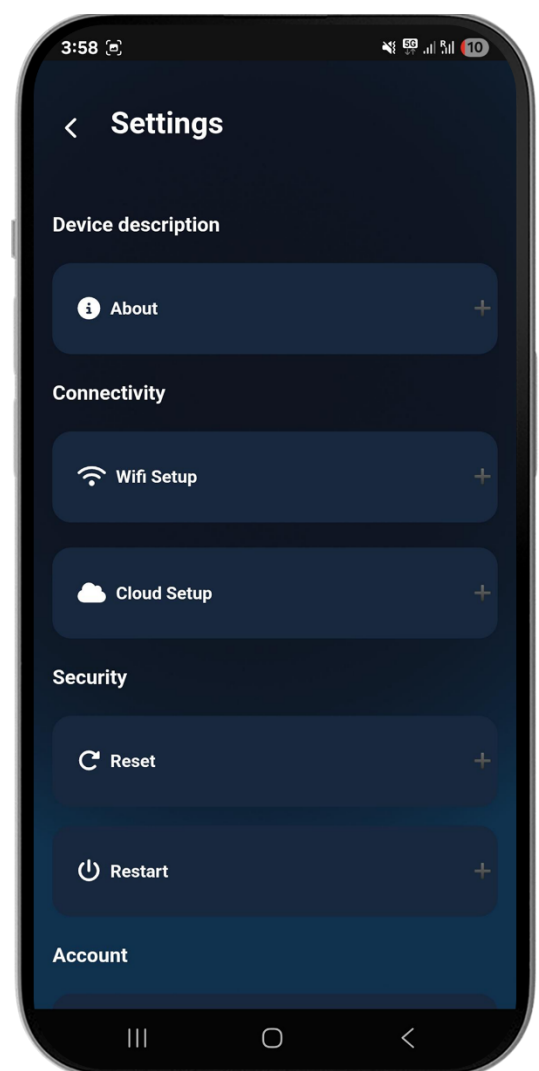

Additional Connections

- **Connection where the fuse is next to the electrical panel switch (Parallel Connection)**

With this setup, the appliance (light, refrigerator, heating, etc.) can be switched on using either BoatControl or the electrical panel switch. The appliance will only be disconnected when both the BoatControl channel/switch and the electrical panel switch are turned off.

In this connection, the electrical panel switch is always off and can be used to override BoatControl if needed.

The BoatControl channel wires are connected on either side of the switch on the electrical panel.

- **Connection where the fuse is built into the electrical panel switch (Serial Connection)**

This is used when the electrical panel switch has a built-in automatic fuse.

Here, the appliance (light, refrigerator, heating, etc.) can be switched on using BoatControl, as long as the electrical panel switch is on.

With this setup, the electrical panel switch is always on and should only be turned off if BoatControl needs to be overridden (see the Override section).

The BoatControl channel is installed between the switch and the appliance (light, refrigerator, heating, etc.).

- **Safety**

For connections where the fuse is next to the electrical panel switch (Parallel Connection):

1. Turn off the power to BoatControl
2. Turn on the necessary equipment via the boat's electrical panel

For connections where the fuse is built into the electrical panel switch (Serial Connection):

1. Turn off all switches on the boat's electrical panel
2. Hold down the manual switch on BoatControl for 5 seconds to activate all channels
3. Turn on the necessary equipment via the boat's electrical panel

Warranty

- The warranty covers 1 year from the date of purchase. If your device was purchased from a store or directly from us, you must provide a copy of the receipt.
- The warranty becomes void if you do not comply with this user manual or if you attempt to repair or modify the product without written permission from BoatControl.
- In case of a claim, the device must be sent to EPTechnologies ApS, Denmark.
- The warranty covers repair/replacement of your device but does not cover any installation, configuration, or shipping costs.
- The manufacturer's liability for damage occurring during use or installation is limited to the value of the unit.
- The manufacturer is not responsible for errors or inaccuracies in manuals and instructions from other companies.
- The manufacturer accepts warranty inquiries and provides technical support via email or through authorized dealers.
- Contact details and a list of authorized dealers can be found at the end of this document or on our website.
- Ensure that the seal is not broken before purchase; the manufacturer will not accept returns if the seal has been broken.

If you experience any issues, contact us at:

 **Email:** support@epttechnologies.de

 **Phone:** +45 30 20 96 94

We will get back to you quickly. **Thank you!**